

DO NOT SCALE FROM THIS DRAWING. USE FIGURED DIMENSIONS IN ALL CASES.  
 VERIFY DIMENSIONS ON SITE AND REPORT ANY DISCREPANCIES TO THE ARCHITECTS IMMEDIATELY. THIS DRAWING TO BE READ IN CONJUNCTION WITH THE ARCHITECTS SPECIFICATION. © THIS DRAWING IS COPYRIGHT AND MAY ONLY BE REPRODUCED WITH THE ARCHITECTS PERMISSION.

NOTES

Ordnance Survey Ireland, Licence No. AR-0052220  
 Ordnance Survey Ireland, Government of Ireland  
 Ordnance Survey Ireland Map Number:

1:2500: 3454-A  
 1:1000: 3391-22  
 3391-21

— SITE BOUNDARY (AREA 21,734SQM - 2.17HA)  
 — LANDS UNDER THE APPLICANTS OWNERSHIP

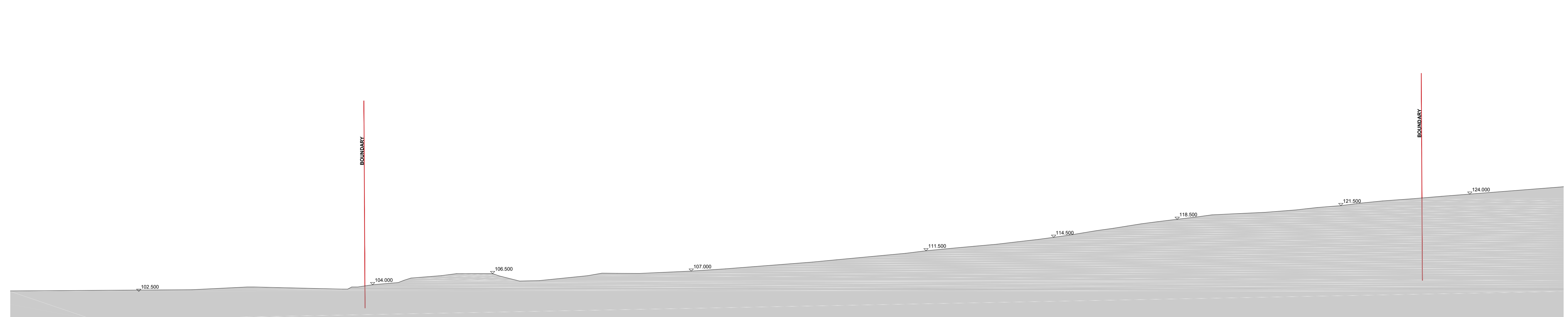

1 EXISTING SITE SECTION  
 1:500

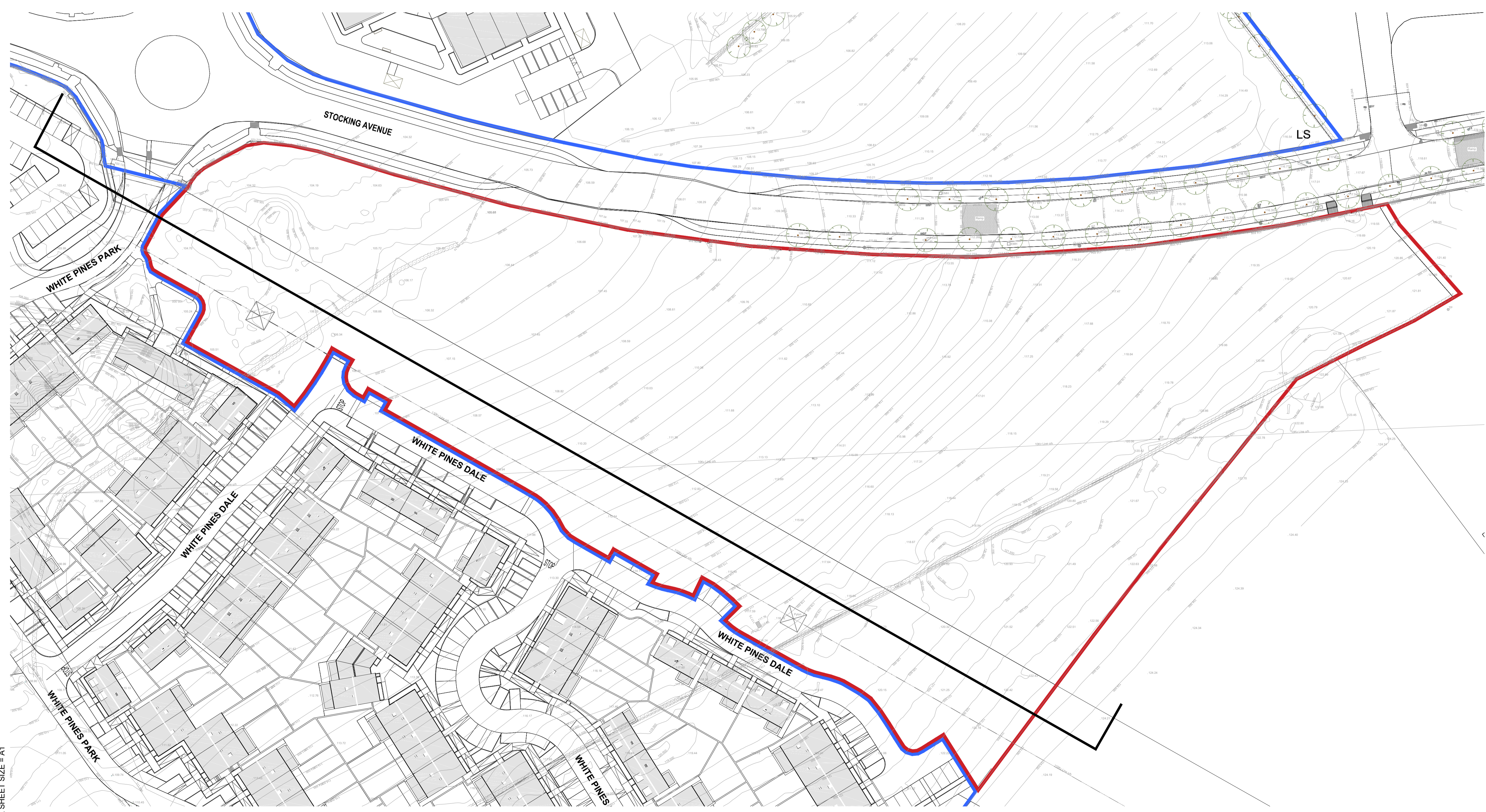

2 TOPOGRAPHICAL SURVEY  
 1:500

P1	May 2021	CMcN	Planning Issue
REV	DTE	DRN	ISSUE

**reddy**architecture+urbanism

Reddy Architecture + Urbanism  
 Dublin Office  
 Cherty Mills, Cherty Road, Dublin 6.  
 T: +353 (0)1 4987000  
 W: www.reddyarchitecture.com  
 E: info@reddyarchitecture.com

PLANNING APPLICATION

JOB  
 Residential Development at Lands South of Stocking Avenue

CLIENT  
 Ardstone Homes Limited

DRAWING  
 Topographical Survey, Existing Site Section

DATE	May 2021	SCALE	1:500 @ A1
DRN	CMcN	CHECKED	AL

JOB NO.	DWG NO.	REVISION
P18-153D	3.1_015	P1

ORIGINAL SHEET SIZE = A1